

CXBN High Feed Face Milling



***High Feed Face Milling Offers
Increased Productivity !!!***



- *The CXBN Mini milling cutters offer exceptional milling performance.*
- *The BNMX0603 and BNMX0904 high feed inserts allow lowest cutting force to insure maximum productivity!*
- *Many insert geometries, wide range cutting applications, strong insert clamping and solid high feed design insure higher efficient performance!*
- *Let the CXBN stream line improve your milling process!*

CXBN High Feed Face Milling

Insert Specifications

Insert	Dimensions (mm)			
	A	B	S	d1
BNMX0603	9.0	6.38	3.75	3.2
BNMX0904	11.9	9.18	4.8	4.2

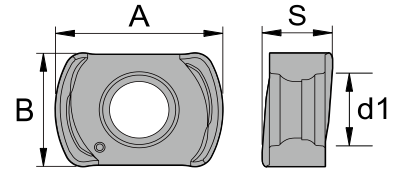

Insert Order Code

Insert	Order No.	Designation	Working Material					
			P	M	K	N	S	H
	IBNMX0603SG22HS	BNMX0603-SG-CX22HS	●	●	●		○	●
	IBNMX0603SG23TS	BNMX0603-SG-CX23TS	●	●	●		●	●
	IBNMX0603SG32HS	BNMX0603-SG-CX32HS	●	●	●		○	○
	IBNMX0603SG33TS	BNMX0603-SG-CX33TS	●	●	●		●	●
	IBNMX0603SG43TS	BNMX0603-SG-CX43TS	●	●	●		●	
	IBNMX0603MG22HS	BNMX0603-MG-CX22HS	●	●	●		○	●
	IBNMX0603MG23TS	BNMX0603-MG-CX23TS	●	●	●		●	●
	IBNMX0603MG32HS	BNMX0603-MG-CX32HS	●	●	●		○	○
	IBNMX0603MG33TS	BNMX0603-MG-CX33TS	●	●	●		●	●
	IBNMX0603MG43TS	BNMX0603-MG-CX43TS	●	●	●		●	
	IBNMX0603RG22HS	BNMX0603-RG-CX22HS	●	●	●		○	●
	IBNMX0603RG23TS	BNMX0603-RG-CX23TS	●	●	●		●	●
	IBNMX0603RG32HS	BNMX0603-RG-CX32HS	●	●	●		○	○
	IBNMX0603RG33TS	BNMX0603-RG-CX33TS	●	●	●		●	●
	IBNMX0603RG43TS	BNMX0603-RG-CX43TS	●	●	●		●	
	IBNMX0904MG22HS	BNMX0904-MG-CX22HS	●	●	●		○	●
	IBNMX0904MG23TS	BNMX0904-MG-CX23TS	●	●	●		●	●
	IBNMX0904MG32HS	BNMX0904-MG-CX32HS	●	●	●		○	○
	IBNMX0904MG33TS	BNMX0904-MG-CX33TS	●	●	●		●	●
	IBNMX0904MG43TS	BNMX0904-MG-CX43TS	●	●	●		●	

Corner R Programming

Designation	Approx. R (mm)	
	Input. R	Uncut
BNMX0603	2.0	0.42
BNMX0904	2.5	0.61

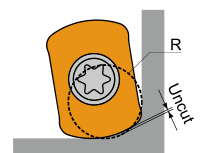

CXBN High Feed Face Milling

Recommended Cutting Conditions

Working Material	for BNMX0603			for BNMX0904		
	Vc	fz	ap	Vc	fz	ap
Carbon Steel / Alloy Steel	120 ~ 250	0.4 ~ 1.6	0.3 ~ 0.9	120 ~ 250	0.4 ~ 2.0	0.3 ~ 1.4
Stainless Steel	100 ~ 180	0.3 ~ 1.2	0.3 ~ 0.7	100 ~ 180	0.3 ~ 1.6	0.3 ~ 1.2
Cast Iron	120 ~ 250	0.4 ~ 1.6	0.3 ~ 0.9	120 ~ 250	0.4 ~ 2.0	0.3 ~ 1.4
High Temperature Alloy	40 ~ 100	0.3 ~ 0.8	0.3 ~ 0.6	40 ~ 100	0.3 ~ 1.2	0.3 ~ 1.2
Hardened Steel	50 ~ 100	0.3 ~ 1.0	0.3 ~ 0.6	50 ~ 100	0.3 ~ 1.4	0.3 ~ 1.2

CXBNE - Milling tools

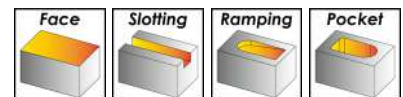
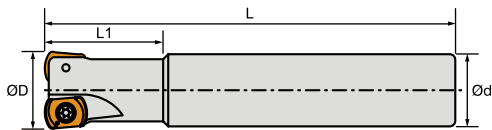

Order No.	D	L1	L	d	T	Inserts	Screw	Wrench	Stock
ICXBNE602015130	15	26	130	16	2	BNMX0603	ITS3004	ITK08	●
ICXBNE602016130	16	26	130	16	2				●
ICXBNE602017130	17	26	130	16	2				●
ICXBNE602018130	18	25	130	20	2				●
ICXBNE603020150	20	40	150	20	3				●
ICXBNE603021150	21	40	150	20	3				●
ICXBNE604025150	25	40	150	25	4				●
ICXBNE604026150	26	30	150	25	4				●
ICXBNE604032200	32	45	200	32	4				●
ICXBNE903025150	25	40	150	25	3	BNMX0904	ITS4009	ITK15	●
ICXBNE903032150	32	40	150	32	3				●

● stock ○ by inquiry

Customize available.

CXBN High Feed Face Milling

CXBNM - Modular tools

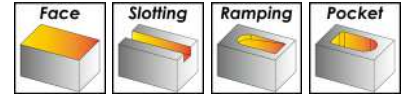
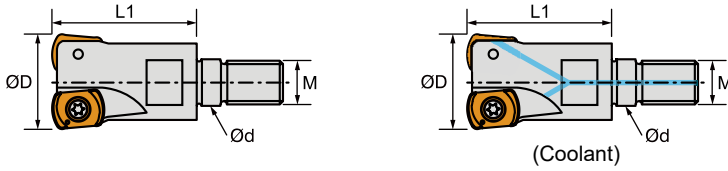

Order No.	D	L1	d	M	T	Coolant Hole	Inserts	Screw	Wrench	Stock
ICXBNM602016080	16	26	8.5	M8	2		BNMX0603	ITS3004	ITK08	●
ICXBNM602016081	16	26	8.5	M8	2	✓				●
ICXBNM603020100	20	30	10.5	M10	3					●
ICXBNM603020101	20	30	10.5	M10	3	✓				●
ICXBNM603021100	21	30	10.5	M10	3					●
ICXBNM603025120	25	35	12.5	M12	3					●
ICXBNM604025120	25	35	12.5	M12	4					●
ICXBNM604025121	25	35	12.5	M12	4	✓				●
ICXBNM603026120	26	35	12.5	M12	3					●
ICXBNM604032161	32	40	17.0	M16	4	✓				●
ICXBNM605032160	32	40	17.0	M16	5					●
ICXBNM606040161	40	43	17.0	M16	6	✓				●
ICXBNM903025121	25	35	12.5	M12	3	✓				BNMX0904
ICXBNM904032161	32	40	17.0	M16	4	✓	●			
ICXBNM904035161	35	43	17.0	M16	4	✓	○			
ICXBNM905042161	42	43	17.0	M16	5	✓	●			
							●			

Customize available.

CXBNF - Milling tools

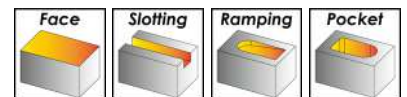
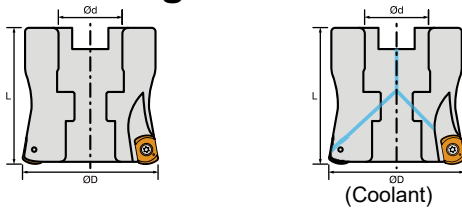

Order No.	D	L	d	T	Coolant Hole	Inserts	Screw	Wrench	Stock
ICXBNF606040220	40	50	22	6		BNMX0603	ITS3004	ITK08	●
ICXBNF606040221	40	50	22	6	✓				●
ICXBNF607050220	50	50	22	7					●
ICXBNF607050221	50	50	22	7	✓				●
ICXBNF607052221	52	50	22	7	✓				○
ICXBNF607063220	63	50	22	7		BNMX0904	ITS3504	ITK15	●
ICXBNF906050221	50	50	22	6	✓				●
ICXBNF906052221	52	50	22	6	✓				●
ICXBNF907063220	63	50	22	7			ITS4009		●
ICXBNF907063271	63	50	27	7	✓		ITS3504		●
ICXBNF907066271	66	50	27	7	✓				○
ICXBNF908080271	80	50	27	8	✓				●
ICXBNF908100321	100	50	32	8	✓		●		

● stock ○ by inquiry

Customize available.